

NOTES

Space Categories

- Admin
- Ancillary
- Circulation
- General Teaching
- Halls
- Learning Resource
- Light Practical
- Plant
- Storage

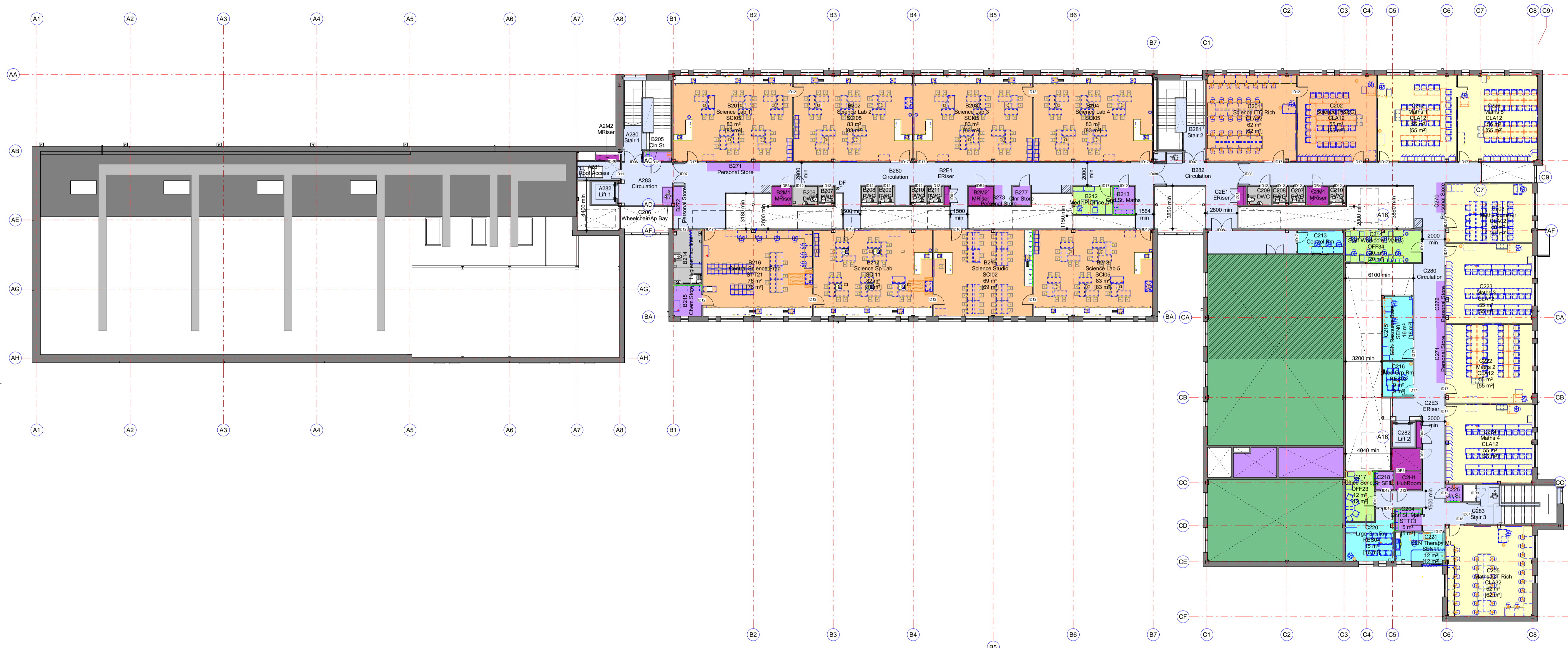

1 Proposed Second Floor Plan
1:200

Mark	Date	Details	By	Rwd
REVISIONS				
Employer:				
 Education Funding Agency				
Contractor Client:				
 Interserve Construction Ltd 351 George Road, Erith, London, SE8 7RZ Tel: 0121 344 4888, Fax: 0121 3444 4801 www.interserve.com				
Project Title:				
Hertfordshire, Luton and Reading PSBP - PF2				
Key Plan:				
Scales: 1:200 for the Original Drawing Size of: A1				
Dm By: Author		Rwd By: Passed By:		Date: 09/28/15
Drawing Status:				
PRELIMINARY				
Drawing Originator:				
Rock Townsend The Old School Exton Street London SE1 8UE tel: 020 7261 9577 www.rocktowntsend.co.uk				
Drawing and design copyright of				
Bishop's Hatfield Girls School Second Floor Plan				
School:	Originator Job No:	Zone-Level-Type-Role-Number:	Revision:	
BH	RT13020	SK159016M		