

NOTES

Space Categories

- Admin
- Ancillary
- Changing Rooms
- Circulation
- Dining
- General Teaching
- Halls
- Learning Resource
- Light Practical
- Plant
- Storage

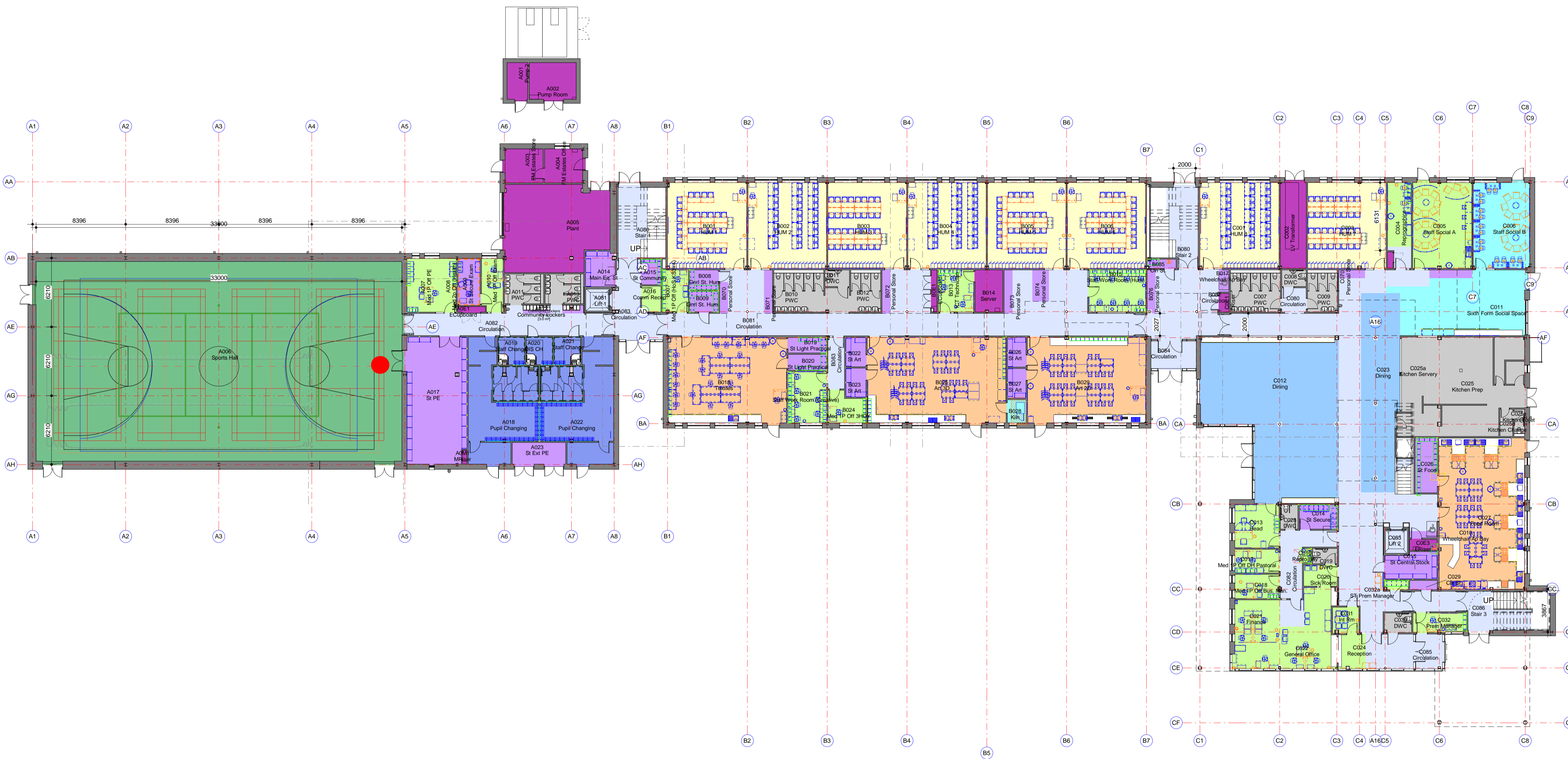

1 00\_Ground Floor  
1 : 200

Mark	Date	Details	By	Rwd
REVISIONS				
Employer: Education Funding Agency				
Contractor Client: Interserve in KAJIMA Interserve Construction Ltd 35 George Road, Enniscorthy, Wexford, E03 7R2 Tel: 0121 344 4888, Fax: 0121 3444 4801 www.interserve.com				
Project Title: <b>Hertfordshire, Luton and Reading PSBP - PF2</b>				
Key Plan:				
Scales: 1 : 200 for the Original Drawing Size of: A1				
Dm By: Author Rwd By: Passed By: Date: 09/28/15				
Drawing Status: <b>PPRELIMINARY</b>				
Drawing Originator: <b>Rock Townsend</b> The Old School Exton Street London SE1 8UE tel: 020 7261 9577 www.rocktownsend.co.uk				
Drawing and design copyright of Drawing Title: <b>Bishop's Hatfield Girls School Ground Floor Plan</b>				
School:	Originator Job No:	Zone-Level-Type-Role-Number:	Revision:	
BH	RT13020	SK159016K		